



ASPIRE

— TO MOVE —



Bedford Court, Bath, BA1

Video and physical viewings are available on this well-presented studio apartment, situated within the popular Bedford Court development. Offered on a furnished basis, the property will be available from 3rd August.

Bedford Court is conveniently located just off London Road, providing excellent access to Bath city centre. A regular bus service can be found approximately 0.1 miles from the development, while a range of local amenities, including a Morrisons supermarket, are available within 0.2 miles. The location also offers easy access to the A4 and surrounding areas, making it ideal for commuters and those seeking convenient city living.

£1,195 PCM

Bedford Court, Bath, BA1

- Studio apartment within the popular Bedford Court development
- Allocated parking space
- Council Tax Band A (£1,550.18 per annum)
- Video and physical viewings available
- Access to attractive riverside communal gardens
- Ideal for a professional couple or single occupier
- Available from 3rd August
- Furnished with bedside tables, wardrobe, TV unit, sofa and dining table with chairs
- Holding deposit: £275

The accommodation comprises a well-designed open-plan living space incorporating the kitchen, living area, dining area and bedroom. The property is furnished with a double bed and mattress, bedside tables, wardrobe, TV unit, sofa, and dining table with chairs, providing a comfortable and practical living environment.

The kitchen is fitted with a range of wall and base units and includes an oven, hob, extractor hood, and fridge with freezer compartment. The bathroom is equipped with a white suite comprising a bath with shower over, wash hand basin, and WC. A useful storage cupboard houses the washer/dryer and hot water tank.

Residents of Bedford Court benefit from an allocated parking space and access to attractive communal riverside gardens, offering a peaceful outdoor space to enjoy.

Offered furnished and available from 3rd August, the property would ideally suit a professional couple or single occupier. Students may also be considered.

Council Tax Band A – £1,550.18 per annum.

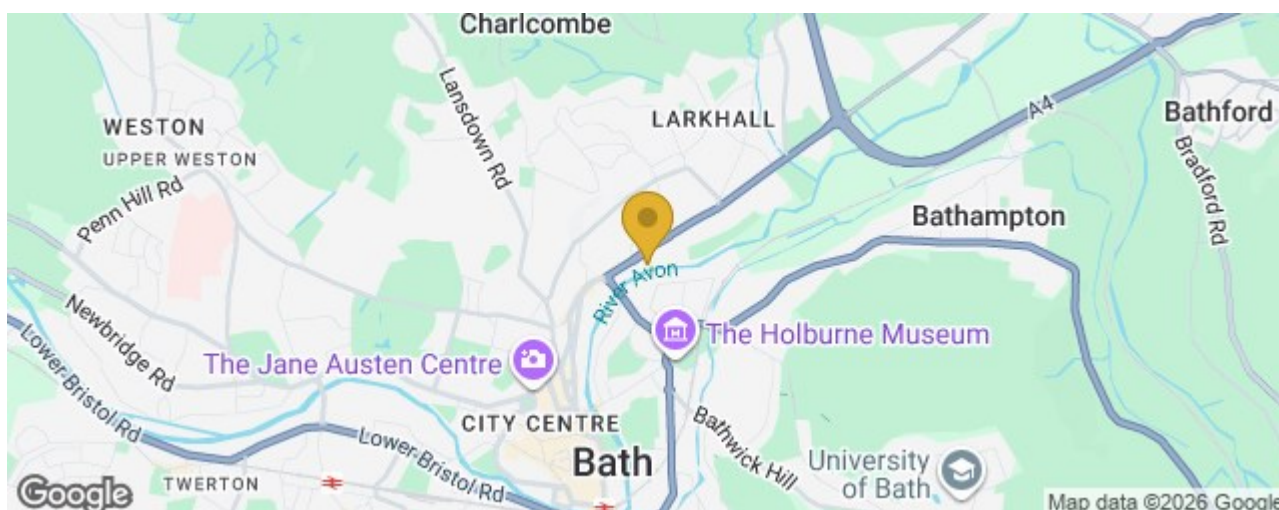



Floor Plan

GROUND FLOOR
373 sq.ft. (34.7 sq.m.) approx.

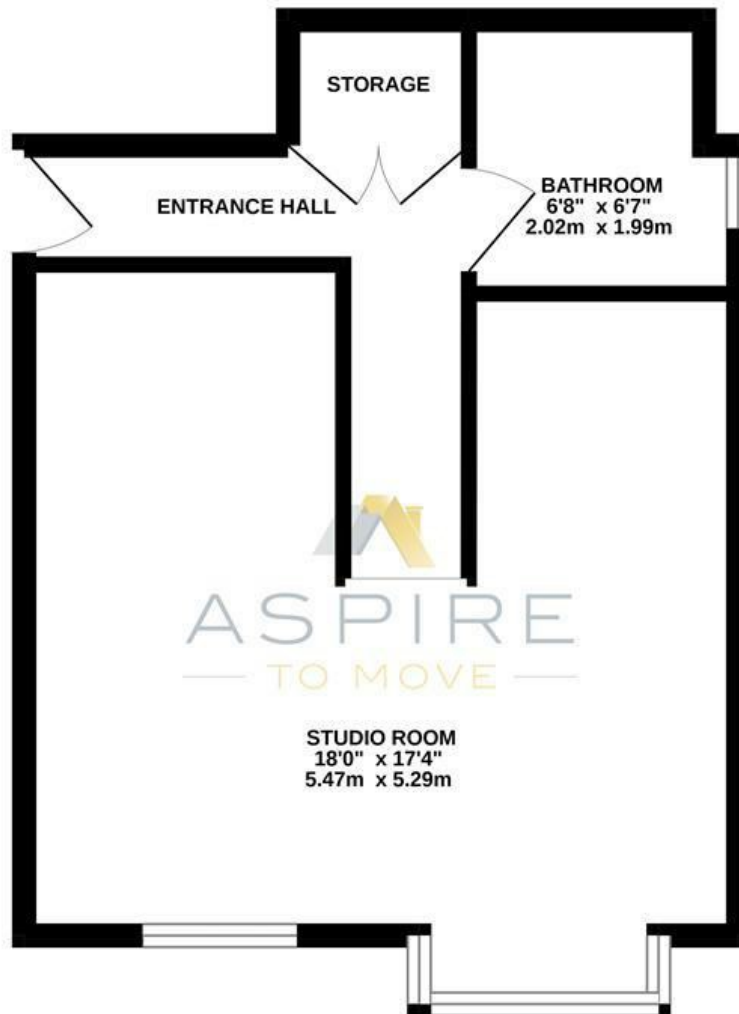

BEDFORD COURT, BATH, BA1

TOTAL FLOOR AREA: 373 sq.ft. (34.7 sq.m.) approx.

Whilst every attempt has been made to ensure the accuracy of the floorplan contained here, measurements of doors, windows, rooms and any other items are approximate and no responsibility is taken for any error, omission or mis-statement. This plan is for illustrative purposes only and should be used as such by any prospective purchaser. The services, systems and appliances shown have not been tested and no guarantee as to their operability or efficiency can be given.
Made with Metropix ©2022.

These particulars, whilst believed to be accurate are set out as a general outline only for guidance and do not constitute any part of an offer or contract. Intending purchasers should not rely on them as statements of representation of fact, but must satisfy themselves by inspection or otherwise as to their accuracy. No person in this firm's employment has the authority to make or give any representation or warranty in respect of the property.

